

Since 1995, we focus on switches

DB-6 系列电源插座

Rating:

5A 250V AC T105  Approval

2.5A 250V AC  Approval

Insulation resistance: 1000MΩ(min)500V DC

Dielectric withstand voltage: 2500V AC 5s Between terminals

DB-6-1P14P6

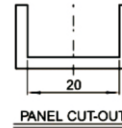
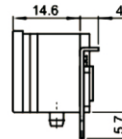
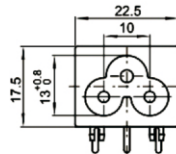
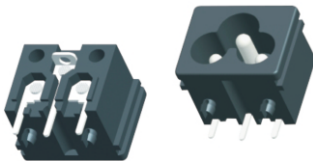

CODE	DIMENSION
A	0.8
	1
	1.5
	2

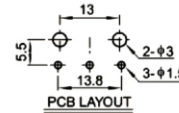
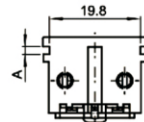

DB-6-1WP14P6

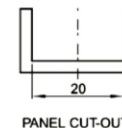
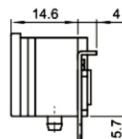
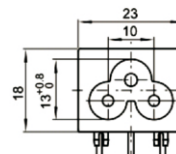
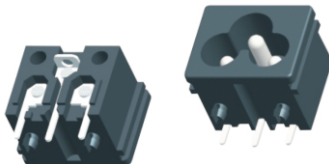

CODE	DIMENSION
A	0.8
	1
	1.5
	2

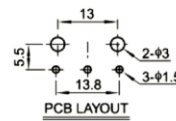
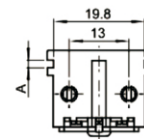

DB-6-2S1S1

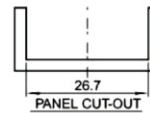
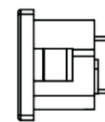
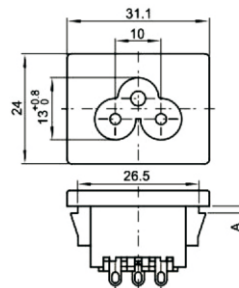
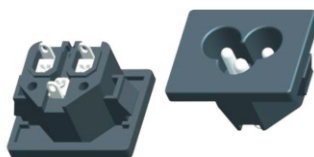

CODE	DIMENSION
A	0.8
	1
	1.5
	2

DB-6-4P5P3

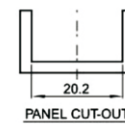
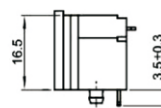
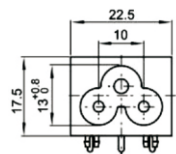
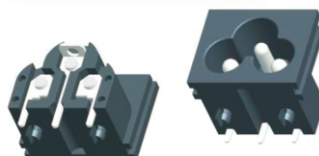

CODE	DIMENSION
A	0.8
	1
	1.5
	2

